

1H



Ignition Switch Removal and Installation

Removal

For E.U. and Australia:

- 1) Remove the steering stem upper bracket.
- 2) Remove the ignition switch mounting bolts (1) with a chisel.
- 3) Remove the ignition switch (2).

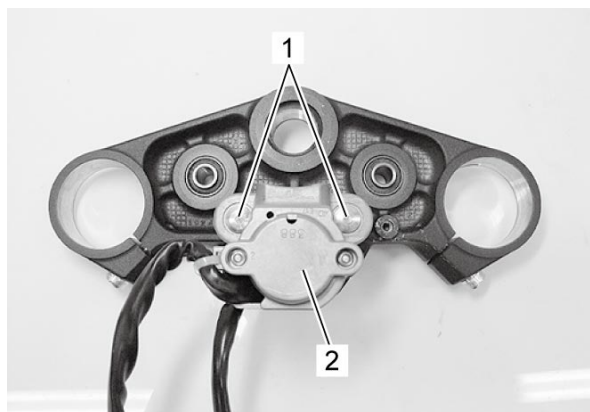

Except for E.U. and Australia

- 1) Remove the air cleaner box.
- 2) Disconnect the ignition switch couplers (1).



- 3) Remove the clamps (1).



- 4)** Remove the ignition switch (1) with the special tools.

Special Tool

09930-11920

09930-11940



- 5)** Remove the ignition switch cover (1).



Installation

Install the ignition switch in the reverse order of removal. Pay attention to the following points:

For E.U. and Australia

- Tighten new ignition switch mounting bolts (1) with the special tool until head of each bolt is broken off.

Special Tool

09930-11940

09940-63110

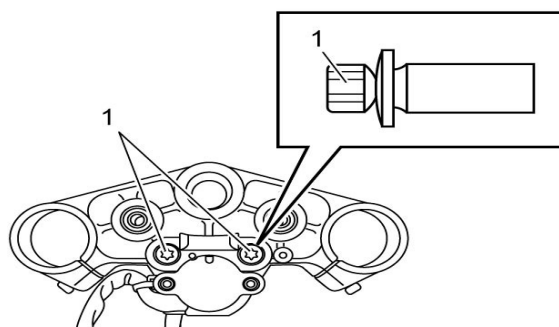

Except for E.U. and Australia

- When reusing the ignition switch mounting bolts (1), clean the thread part and apply the thread lock to them.

"A": Thread lock cement 99000-32150 (THREAD LOCK CEMENT 1322D)

- Tighten the ignition switch mounting bolts (1) with the special tools.

Special Tool

09930-11920

09930-11940

